



C HUB BEARING ADDENDUM

ALTERNATE BEARING FOR C HUB ASSEMBLIES

As of January 2021, Martin C-Hub assemblies are machined with a secondary groove to allow for substituting two 205RVA Bearings (800640) for the standard W5205RSS51 (800248) as shown below.

If changing from a W5205RSS51 to 2x 205RVA Bearings, follow the below steps.

1. Unbolt the Wheel and Hub assembly from the Frame by removing the Dust Cap and 5/8 Hex Bolt from Front of Hub.
2. Remove Bushing (800241) from the hub (With the 2 x 205RVA Bearings, this bushing will not be needed).
3. Remove Retainer Ring (800238) from front groove and pull out the W5205RSS51 Bearing.

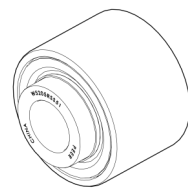

**W5205RSS51
BEARING**



**205RVA
BEARING**

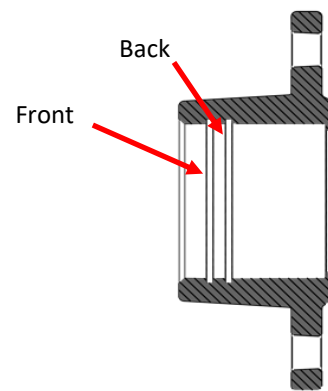

5. Install the first 205RVA bearing with the stem (extended Inner race) facing out towards the front of the hub as shown.
6. Install second bearing with stem facing out towards the back of the hub as shown.

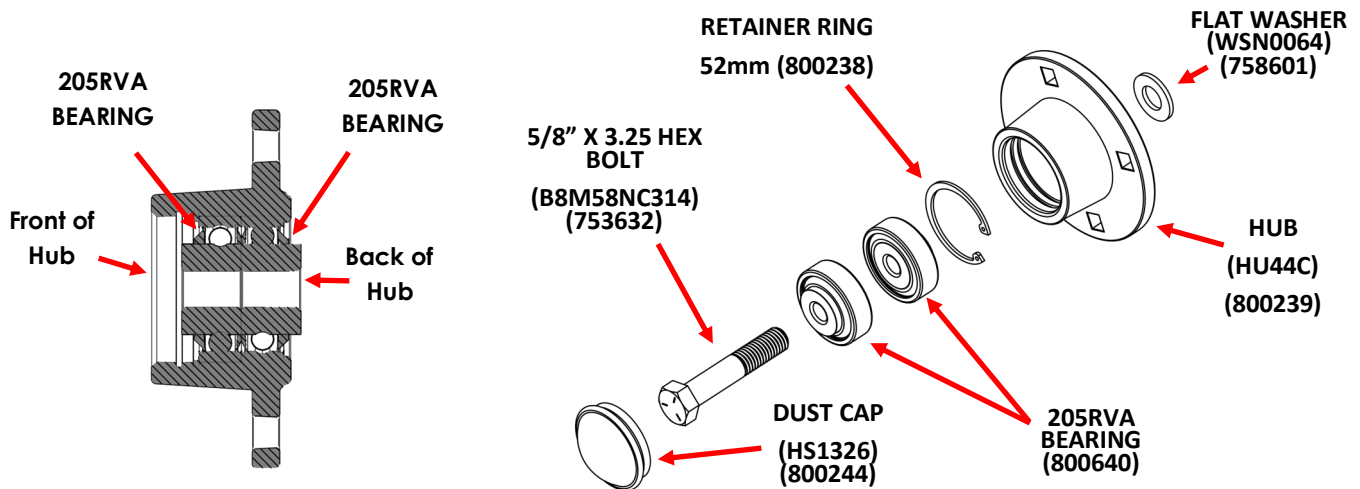

7. Reinstall Retainer Ring (800238) in the Back snap ring groove shown in Step 3 image.
8. When reinstalling the Wheel and Hub assembly, add an extra 5/8 Washer (758601) behind the bearing. If using scrapers, this will mean having a washer between the bearing and the scraper. If not using scrapers, two washers will be between the bearing and frame.
8. Torque 5/8 bolt to 150 ft-lbs. and reinstall Dust Caps.

REVISED 6-21-2024